

# Hydrostatic Test Rigs



- Hydrostatic testing of pipes & vessels both onshore & offshore
- Fast filling pump options e.g. 50m<sup>3</sup>/hr @ 10.3 Bar
- Mid pressure system options e.g. 300 Bar @ 150 l/min
- Hydrostatic air driven test pump e.g. 400 l/hr @ 1034 Bar

Model	Hydrostatic Test Rigs (example specification)
<b>Pressure and Flow (examples)</b>	Filling (FS): 50m <sup>3</sup> /hr @ 10.3 Bar Mid pressure system (MPS): 180 lpm @ 210 Bar Hydrostatic test pump (HTU): 400 lph @ 1034 Bar
<b>Pump</b>	Aqua AHF 215 three cylinder positive displacement plunger pump/Harben radial diaphragm pump Air driven hydrostatic test pump dual piston 1034 Bar
<b>Chemical Injection</b>	Optional automated and manual chemical injection available on both fill and test systems
<b>Motor/Starter</b>	Motors are IP55 rated for ingress protection. Star Delta 90kW motor controlled via Red Lion HMI.
<b>Control System</b>	Remote control available with full downloadable data logger availability and touch screen operation
<b>Services Required</b>	Air supply: 9 Bar @ 400 scfm Electrical supply: 440v 3 phase 60 Hz (other options available upon request) Sea water: FS pump flooded capable of 50m <sup>3</sup> /hr flooded
<b>Pressure Relief Valve</b>	PRV set to 10% WP. Lloyd's Register certification available upon request.
<b>Pressure Regulating Valve</b>	Pneumatic operated pressure regulating valve controlled via Red Lion HMI
<b>Sampling</b>	Fluid sampling on tank, pressure line and return
<b>Supply Tank</b>	1000 litre supply tank manufactured from 316 stainless steel. Full temperature and level monitoring via HMI.
<b>Cooling</b>	Dump pump capable of emptying tank at 180 lpm
<b>Frame</b>	Mild steel SHS tested and certified to 1.5 SWL. Supplied with approved lifting eyes for transportation.
<b>Filtration</b>	50 micron inline filter to supply tank.
<b>Dimensions</b>	3500mm Long x 1800mm Wide x 2000mm High **
<b>Weight</b>	Dry weight: From 3600 kgs **

\*These units are bespoke to suit customer's requirements

\*\* All weights and dimensions are subject to change and should be confirmed with Flowplant at time of quotation and ordering

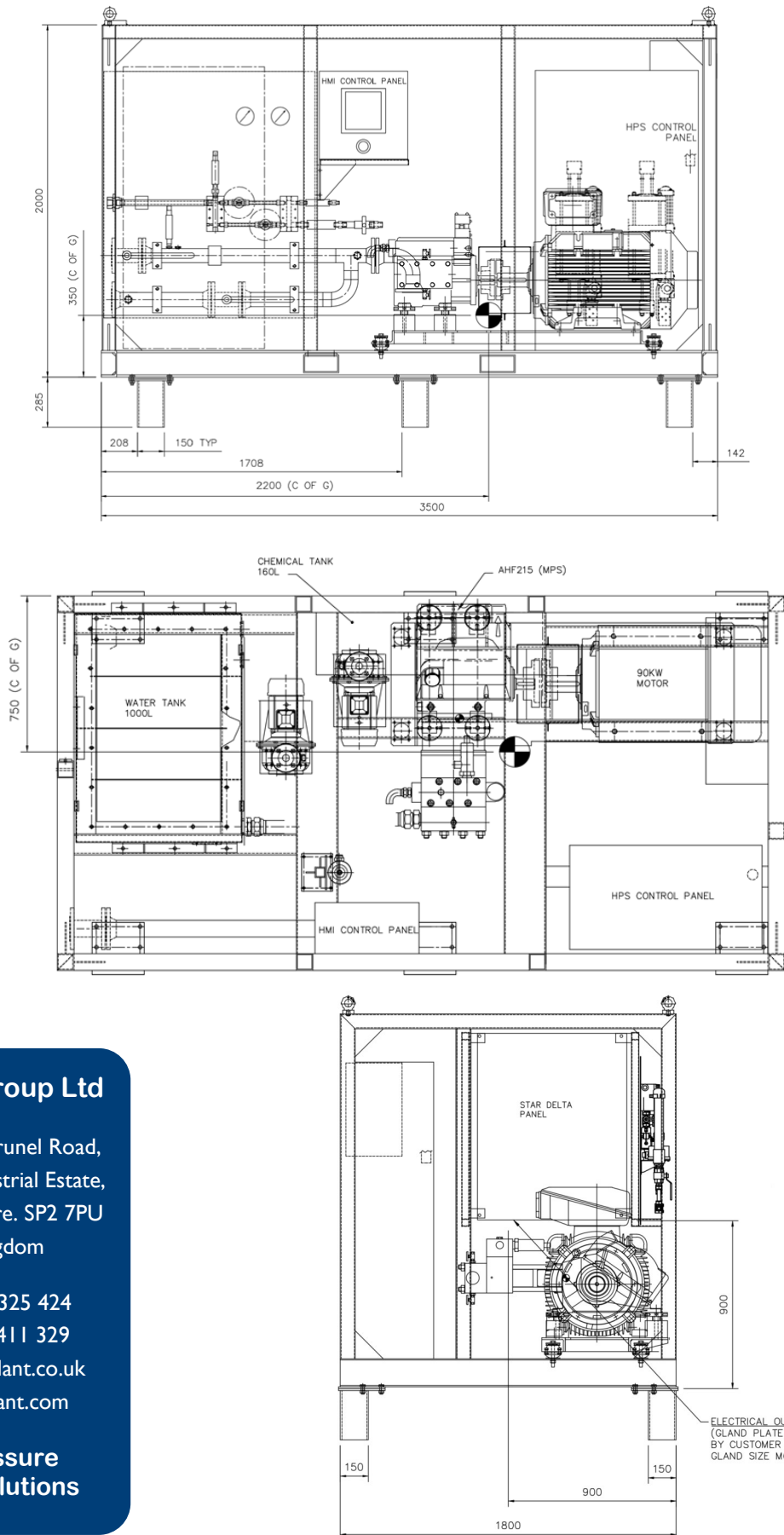

## Flowplant Group Ltd

Gemini House, Brunel Road,  
Churchfields Industrial Estate,  
Salisbury, Wiltshire. SP2 7PU  
United Kingdom

t: +44 (0)1722 325 424

f: +44 (0)1722 411 329

e: [sales@flowplant.co.uk](mailto:sales@flowplant.co.uk)

w: [www.flowplant.com](http://www.flowplant.com)

**High Pressure  
Cleaner Solutions**